

# KOLVER



  
**KOLVER**<sup>®</sup>  
**USA**

ELECTRIC SCREWDRIVERS

Founded in 1989, Kolver has become a market leader in the manufacturing of AC and DC precision electric screwdrivers serving a wide variety of industries.

Thousands of state-of-the-art drivers are produced every year in Italy and then shipped to more than 30 countries worldwide. ISO 9001 certified since 1998, KOLVER has gained international recognition for building premier quality innovative products that meet or exceed the most rigorous customer requirements. More than 80% of the products you find in this catalogue have been introduced over the last 2 years: no other manufacturer of electric screwdrivers comes close to this record.

*Screwdriver is the term commonly used for assembly tools in the screw size up to M8. This catalogue is designed to help you select the right screwdriver for your assembly application. The Kolver family of tools is one of the most complete in the electric power tool industry. The Kolver line of tools covers a wide range of torque at several speeds, suitable for an infinite number of applications. Whether your job is in the Electronics, Medical, PC assembly, Telecommunication or in the Motor vehicles or Household appliances industry, you'll find the optimum screwdriver for each application.*



## PLUTO SERIES

Kolver's ingenuity and experience have led to the development of Pluto (PLUs TORque) screwdrivers, the most advanced DC tools in the market, able to reach 132 in.lbs of torque (4 times more than any competitor's tool). They feature: an innovative electric motor design with low inertia and friction provides for extreme efficiency and extended life. Planetary gearboxes with high quality composite materials. Pistol grip to fit operator's hand ergonomically.

A weight of 1.3 lbs to reduce operator's fatigue. Fully electronic (clutchless) torque control system, manually set by a dial on the controller, to shut the tool off automatically once the preset torque has been reached. The Pluto Series is ideal for high volume applications where millions of cycles at high torque are required.

The Pluto Series is available in a molded pistol grip with the cord set exiting from the top (U option) or bottom, or in a standard inline housing with lever start. ESD-safe housing is standard. This tool is the real alternative to the pneumatic screwdriver.

The controller is supplied with slow start and adjustable speed, soft or hard joint option, high speed rundown and slow speed tightening for improved accuracy, automatic reverse at cycle end, autostop on elapsed time, torque reached signal and lever signal, remote start and reverse contacts (see page of control units for details) or with PLC option for multiple



functions. All Pluto series electric screwdrivers come standard with 8 ft connection cable and suspension bail. The new heavy duty cables and connectors, developed for robotic applications, are made of anti-static dissipative material for a safe use in ESD environment.



TORQUE SET UP ON THE CONTROLLER



U MODEL



INLINE MODEL WITH ADAPTER KPO5 FOR EASY CLAMPING ON REACTION ARM



PLUTO08ANG

Model	Torque in.lbs	Screw size	RPM max	Start option	Weight lbs	L x Ø in	Voltage cc	Controller	Housing option
PLUTO3D	2.65-26.50	M5	1200	Lever	1.10	8.50x1.60	40 Vcc	EDU1AE/LTP	
PLUTO3P	2.65-26.50	M5	1200	Trigger	1.10	5.90x5.90x1.80	40 Vcc	EDU1AE/LTP	Pistol grip
PLUTO10D/N	18÷88	M6	600	Lever	1.10	8.50x1.60	40 Vcc	EDU1AE	
PLUTO10P/N	18÷88	M6	600	Trigger	1.10	5.90x5.90x1.80	40 Vcc	EDU1AE	Pistol grip
PLUTO10P/U/N	18÷88	M6	600	Trigger	1.10	5.90x5.90x1.80	40 Vcc	EDU1AE	Pistol grip with top connector
PLUTO15D/N	18÷132	M8	320	Lever	1.10	8.50x1.60	40 Vcc	EDU1AE	
PLUTO15P/N	18÷132	M8	320	Trigger	1.10	5.90x5.90x1.80	40 Vcc	EDU1AE	Pistol grip
PLUTO15P/U/N	18÷132	M8	320	Trigger	1.10	5.90x5.90x1.80	40 Vcc	EDU1AE	Pistol grip with top connector
PLUTO08ANG	13.20-70.40	M6	600	Lever	1.65	10.25x1.60	40 Vcc	EDU1AE	

Exact torque range for each Pluto Series Driver is dependent on the joint being assembled, and the Controller selected.



**FAB SERIES**  
(TORQUE UP TO 16 in.lbs)

FAB series electric screwdrivers are our "best sellers" for the electronic industry. Their advanced ergonomic design, ease of use, high accuracy and durability have made these drivers the standard by which all others are measured. They are lightweight, compact, powerful and come standard with ESD-safe housing certified to SP method 2472 (Ericsson approved). The FAB screwdrivers are available in an inline body style with either a lever start or push to start or in a pistol grip with a trigger start (also available with the cord coming out from the top - U option) and different speeds, for different assembly requirements.

The torque is set externally: an adjusting nut controls output torque by changing the clutch spring compression. A reference scale will indicate the torque setting. The low voltage 30 V DC rare earth motors combine high performances and long life. Replacing their carbon brushes once a year is all you need for maintenance.

The motor works in combination with a control unit. The electronic control circuit cuts the power supply to the motor in response to the clutch action, as soon as the pre-set torque has been reached.

Standard features are the slow start (ramp from 0 to 2 seconds) and adjustable speed (from 60% to 100% of nominal speed).

In addition the controller can be supplied with torque reached signal, lever signal, remote start and reverse (see page of control units) or with PLC option.

All FAB drivers come standard with an ESD-safe body, 8 ft connection cable and suspension bail.

The new heavy duty cables and connectors, developed for robotic applications, are made of antistatic dissipative material for a safe use in ESD environment.



FAB SERIES



TORQUE SET UP



PISTOL MODEL



ANGLE HEAD ANG HD6 (ONLY FOR LEVER TYPE)

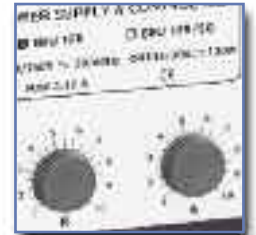

SOFT START AND SPEED REGULATION

Model	Torque in.lbs	Screw size	RPM max	Start option	Weight lbs	L x Ø in	Voltage cc	Controller	Housing option
FAB03SS/FR	0.44÷4.4	M2.5	650	Lever	1	8.90x1.30	30 Vcc	EDU1FR	
FAB10RE/FR	0.44÷7.0	M2.5	1000	Lever	1.10	8.90x1.30	30 Vcc	EDU1FR	
FAB12RE/FR	1.8÷10.60	M3	1000	Lever	1.10	8.90x1.30	30 Vcc	EDU1FR	
FAB12PS/FR	1.8÷10.60	M3	1000	Push start	1.10	8.90x1.30	30 Vcc	EDU1FR	
FAB12PP/FR	1.8÷10.60	M3	1000	Trigger	1.20	7.90x5.90x1.35	30 Vcc	EDU1FR	Pistol grip
FAB12PP/FR/U	1.8÷10.60	M3	1000	Trigger	1.20	7.90x5.90x1.35	30 Vcc	EDU1FR	Pistol grip with top connector
FAB18RE/FR	2.60÷16.0	M4	650	Lever	1.10	8.90x1.30	30 Vcc	EDU1FR	
FAB18PS/FR	2.60÷16.0	M4	650	Push start	1.10	8.90x1.30	30 Vcc	EDU1FR	
FAB18PP/FR	2.60÷16.0	M4	650	Trigger	1.20	7.90x5.90x1.35	30 Vcc	EDU1FR	Pistol grip
FAB18PP/FR/U	2.60÷16.0	M4	650	Trigger	1.20	7.90x5.90x1.35	30 Vcc	EDU1FR	Pistol grip with top connector

## RAF SERIES (TORQUE UP TO 33.60 in.lbs)

RAF Series screwdrivers are designed to meet higher torque applications. The advanced ergonomic body design reduces Carpal Tunnel Syndrome. They are lightweight, compact, powerful and come standard with ESD-safe housing certified to SP method 2472 (Ericsson approved). The RAF series' wide torque range and tight torque accuracy combined with the adjustable RPMs and slow-start options, make it a versatile tool ideal for multiple applications. The RAF screwdrivers are available in an inline body style with either a lever start or push to start or in a pistol grip with a trigger start (also available with the cord coming out from the top - U option) and different speeds, for different assembly requirements.

The torque is set externally: an adjusting nut controls output torque by changing the clutch spring compression. A reference scale will indicate the torque setting. The low voltage 30 V DC rare earth motors combine high performances and long life. Replacing their carbon brushes once a year is all you need for maintenance.

The motor works in combination with a control unit. The electronic control circuit cuts the power supply to the motor in response to the clutch action, as soon as the pre-set torque has been reached. Standard features are the slow start (ramp from 0 to 2 seconds) and adjustable speed (from 60% to 100% of nominal speed).

In addition the controller can be supplied with torque reached signal, lever signal, remote start and reverse (see page of control units) or with PLC option.

All RAF drivers come standard with an ESD-safe body, 8 ft connection cable and suspension bail.

The new heavy duty cables and connectors, developed for robotic applications, are made of antistatic dissipative material for a safe use in ESD environment.



TORQUE SET UP



PISTOL MODEL



ANGLE HEAD ANG HD5  
(ONLY FOR LEVER TYPE)

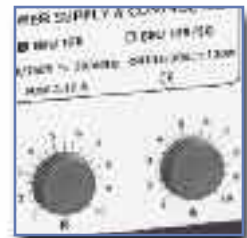

SOFT START AND  
SPEED REGULATION

RAF SERIES

Model	Torque in.lbs	Screw size	RPM max	Start option	Weight lbs	L x Ø in	Voltage cc	Controller	Housing option
RAF32NS/FR	6.20÷28.30	M5	1000	Lever	1.45	9.75x1.60	30 Vcc	EDU1FR	
RAF32PS/FR	6.20÷28.30	M5	1000	Push start	1.45	9.75x1.60	30 Vcc	EDU1FR	
RAF32PP/FR	6.20÷28.30	M5	1000	Trigger	1.55	7.90x5.90x1.35	30 Vcc	EDU1FR	Pistol grip
RAF32PP/FR/U	6.20÷28.30	M5	1000	Trigger	1.55	7.90x5.90x1.35	30 Vcc	EDU1FR	Pistol grip with top connector
RAF38NS/FR	7.95÷33.60	M5	650	Lever	1.45	9.75x1.60	30 Vcc	EDU1FR	
RAF38PS/FR	7.95÷33.60	M5	650	Push start	1.45	9.75x1.60	30 Vcc	EDU1FR	
RAF38PP/FR	7.95÷33.60	M5	650	Trigger	1.55	7.90x5.90x1.35	30 Vcc	EDU1FR	Pistol grip
RAF38PP/FR/U	7.95÷33.60	M5	650	Trigger	1.55	7.90x5.90x1.35	30 Vcc	EDU1FR	Pistol grip with top connector

## BRUSHLESS SERIES (TORQUE UP TO 14.10 IN.LBS)

BRL series electric screwdrivers feature state-of-the-art brushless motors and clutchless torque control, the perfect solution for clean room applications thanks to zero emissions of coal dust and other pollutants into the working environment. Extremely small and lightweight for utmost operator comfort and with advanced ergonomic design, they ensure very low noise level, minimum vibrations, maximum safety (low supply voltage), lasting performance as well as maintenance free operation.

The BRL screwdrivers are available in an inline body style with lever start or pistol grip option (on request also available with the cord coming out from the top - U option).

Three models with a wide range of torque and speed to cover many different assembly requirements.

All BRL drivers come standard with an ESD-safe body, 8 ft connection cable and suspension bail. The heavy duty cables and connectors, developed for robotic applications, are made of antistatic dissipative material for a safe use in EPA environment.

The absence of maintenance operations guarantees high productive continuity.

BRL series work in combination with a control unit acting as universal power supply and fully electronic (clutchless) torque control system to shut the tool off automatically once the preset torque has been reached. The EDU1BR controller comes standard with the adjustable torque knob and the selection of two ranges of torque through a switch in the front panel: L (from 0 to 30 % of the nominal torque range) and H (from 20% to 100 %).

The EDU1BR/SG unit features slow start option (ramp from 0 to 2 seconds), adjustable speed (from 60% to 100% of nominal speed), torque reached and lever signals, remote start and remote reverse options.



EDU1BR/SG  
CONTROL UNIT



TORQUE  
ADJUSTMENT



AUTOMATION  
MODEL



8 PIN CABLE

Model	Torque	RPM Nm	Start max	Weight option	L x Ø kg	Voltage mm	Controller
BRL07AS	0.90÷6.20	1000	Lever	0.75	8x1.30	40V	EDU1BR
BRL10AS	0.45÷8.90	650	Lever	0.75	8x1.30	40V	EDU1BR
BRL16AS	0.90÷14.10	450	Lever	0.75	8x1.30	40V	EDU1BR

### ACC SERIES

ACC screwdrivers are 110V direct plug-in tools with built-in PCB for automatic power cut-off and AC-to-DC rectifier.

Since they do not need a separate control unit, they are perfect for all those applications where the operator frequently needs to shift the tool from one working place to another. ACC drivers have the unique feature of selectable push to start or push & lever start at the flick of a switch to suit any operator's choice.

Equipment supplied with all models: 8 ft cable with connector for controller and a suspension bail.

NOTE: The ACC Series screwdriver body is not made of ESD-safe material.

The body can be coated with a static dissipative material to make it ESD-safe, but the treatment will need to be replaced over time.



TORQUE SET-UP



3 POSITIONS REVERSE SWITCH



START MODE (PUSH TO START OR PUSH + LEVER)



TORQUE ADJUSTING NUT COVER

Model	Torque in.lbs	Screw size	RPM max	Weight lbs	L x Ø in	Voltage cc
ACC2210	1.75÷8.85	M3	950	1.65	10.20x1.40	120 V
ACC2220	6.20÷17.70	M4	950	1.76	10.20x1.40	120 V
ACC2230	8.85÷26.55	M5	950	1.87	10.60x1.52	120 V
ACC2245	8.85÷39.82	M5	450	1.87	10.60x1.52	120 V

### CA SERIES

The CA screwdrivers are designed for automated and fixtured applications. Special wiring and dedicated controllers are equipped with electric signals and contacts for immediate and easy interface.

The ideal alternative to pneumatic drivers, they feature a long life maintenance free electric motor with a unique electronic torque control system for high accuracy throughout a wide torque range; an aluminium body, for easy and quick clamp, supplied with 8 ft cable.

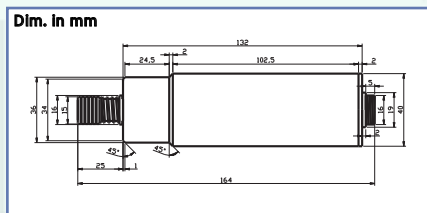

PLUTO CA

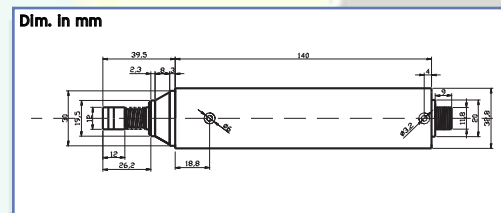

BRL CA



Model	Torque in.lbs	RPM max	Start option	L x Ø in	Voltage cc	Controller
PLUTO3CA	2.65-26.50	1200	Remote	6.45x1.60	40 Vcc	EDU1AE/LTP
PLUTO10CA/N	18÷88	600	Remote	6.45x1.60	40 Vcc	EDU1AE
PLUTO15CA/N	18÷132	320	Remote	6.45x1.60	40 Vcc	EDU1AE
PLUTO20CA/N	22.50÷176	130	Remote	8.20x1.86	40 Vcc	EDU1AE/20
BRL07AS/CA	0.90-6.20	1000	Remote	5.50x1.30	40 Vcc	EDU1BR/SG
BRL10AS/CA	0.45-8.90	650	Remote	5.50x1.30	40 Vcc	EDU1BR/SG
BRL16AS/CA	0.90-14.10	450	Remote	5.50x1.30	40 Vcc	EDU1BR/SG

ACC - CA SERIES

## CONTROL UNITS

All Kolver screwdrivers work in combination with a control unit acting as an AC to DC transformer and torque controller. The electronic control circuit cuts the power supply to the motor as soon as the pre-set torque has been reached.

The new EDU1FR control units for FAB and RAF screwdrivers feature maintenance free state-of-the-art electronics with no wearing components with a circuit design suitable to both lever start and push start drivers with protection against current overload up to 10A. This design results in very low current to the driver's start switch and clutch switch to extend their life indefinitely.

Additional features:

- Suitable to universal supply from 90 to 260 V ac 50/60 hz.
- Slow start (0-2 seconds) and RPM (60% to 100%).
- Visual indicators (green-red) for power on/off and clutch action.
- Reduced weight (1.33 lbs) and compact size for easy placement.
- M12 waterproof connector with silver and gold contacts for perfect conductivity.

The EDU1FR/SG controller features additional circuits wired to 2 connectors in the back panel: one connector sends out 24V signals for torque reached and lever (motor running), the second connector is designed to accept remote start and remote reverse signals. A double output connector (DOCK01) is also available for operators using two screwdrivers on the same working area. One end of this device is to be connected to the controller (cable included), the other end to the drivers. The screwdrivers are not to be used at the same time.

For the Pluto series the EDUIAE gives you all the advantages of precision torque controlled electric tools at a fraction of the price of transdurized tools. The microprocessor based unit cuts the power supply to the motor calculating the correct torque in response to 3 parameters; voltage, frequency, and current, according to the selected options.

Additional features:

- One controller only for a torque range from 18 to 132 in.lbs: EDUIAE.
- One controller for lower torque range from 5.30 to 60 in.lbs: EDUIAE/LTP.
- User interface screens: walk through a few simple steps to input the parameters requested for your application and your fastening process can begin.
- Slow start and adjustable speed.
- Soft or hard joint option.
- High speed rundown and slow speed tightening for improved accuracy.
- Autostop on elapsed time, automatic reverse at cycle end with adjustable time stop.
- Torque reached signal and lever signal, remote start and reverse contacts.
- Serial port for data downloading available on request for all models.



TORQUE ADJUSTMENT ON EDUIAE



SOFT START AND SPEED REGULATION



EDU1BR/SG FOR BRUSHLESS SERIES



DOUBLE OUTPUT DEVICE WITH CABLE (DOCK01)

Model	Features	Dimensions in	Weight lbs	Screwdriver
EDU 1FR	In: 90-260Vca out: 18-30Vcc slow start and adjustable speed	5.45x4.65x2.65	1.33	All FAB and RAF
EDU1FR/SG	Input: start and reverse contacts Output: torque reached & lever signal	5.45x4.65x2.65	1.33	All FAB and RAF
EDUIAE	Programmable with user interface screens	7.40x5.00x3.80	6.95	PLUTO
EDUIAE/C/DT	Dual torque controller	7.40x5.00x3.80	6.95	PLUTO
EDUIAE/RT	Remote multiple torque selection	7.40x5.00x3.80	6.95	PLUTO
EDUIAE/LTP	Torque range 5.30-60 in.lbs	7.40x5.00x3.80	6.95	PLUTO
EDU1CL/FR	Blank controller	5.45x4.65x2.65	1.33	All FAB and RAF
EDUIAE/PLC/CC	Multi torque system	7.40x5.60x7.40	8.50	PLUTO
EDUIAE/PLC/CC/LTP	Multi torque system - low torque	7.40x5.60x7.40	8.50	PLUTO



## INSPECTOR CONTROL UNIT

The INSPECTOR is a PLC based process control system that monitors the fastening assembly process: EDU1FR/PLC for the FAB and RAF series; EDU1AE/PLC for the PLUTO driver.

It compares the actual triggered torque time to a pre-set tolerance, ignoring joints that fall out of the process window. It tracks, in real time, the completion of each screw joint in an assembly, then notifies the operator upon its completion. It keeps a summary of good and incomplete assemblies throughout the production day.

Additional features:

- Set up of number of screws for a complete cycle (1 to 99999) and display of completed assemblies, total acceptable and rejected assemblies.
- Set up of minimum fastening time in 0,1 sec. steps (to avoid the counting of torque reached signals obtained re-fastening an already tied up screw or fastening screws that stop before reaching the right position).
- Set up of maximum fastening time (to avoid the counting of stripped screws).
- Remote starting and reversing (option).
- Output signals: torque reached, lever, cycle end and alarm (24 V 100mA).



Model	Power	Dimensions	Weight in	Screwdriver lbs
EDU 1FR/PLC	120VA	5.30x4.55x7.30	2,20	Series FAB and RAF
EDU1AE/PLC	200VA	7.30x5.50x7.30	8,50	Series PLUTO

## CONTROL UNITS WITH PROGRAMMABLE SYSTEM

- The multiple torque system is designed to expand the functionality of the PLUTO screwdriver and EDU1AE controller by enabling easy access to multiple torque settings with one EDU1AE controller and one Pluto driver only. Models include a double torque output unit and a multiple torque unit with remote setting. When used with a socket tray at 8 positions, every time a bit (or socket) is taken out of the tray the unit will automatically switch to the pre-set torque. These control units are extremely flexible and easily adaptable to different applications.
- A special model PLC/TOP is available on request featuring up to 8 programs each one with different torque values, speed, ramp, screw counting, batch counting, USB port for printer and PC connection, torque chart with real time clock.



Model	Power	Dimensions	Weight in	Screwdriver lbs
EDU1AE/PLC/CC	200VA	7.30x5.50x7.30	8,50	Series PLUTO
EDU1AE/TOP	200VA	9x4.75x8.20	8,80	Series PLUTO



## SMART-ARM SYSTEMS FOR MULTI-TORQUE APPLICATIONS



### MODEL #7000147 SMART ARM W/SEQUENCING

The Smart-Arm system guarantees that every screw in your assembly is fastened at the correct torque and location with the right bit/socket.

The system automatically selects torque programs from the PLC Controller by the predefined locations on the parts in your assembly fixture.

A simple Job-Box style control unit is used for programming site location, bit/socket, torque program, all in a programmed sequence. No PC is required.

The joint locations can utilize any combination of bit/socket from the selection tray.

#### SPECIFICATION:

- Arm reach 22", z-axis travel 15" (custom sizes available)
- Eight torque programs
- EDU1AE/PLC/CC controller required.
- EDU1AE/PLC/CC/LTP controller required for low torque

### PROGRAM SELECTION BY LOCATION

The system consists of a torque reaction arm with encoders at the two pivot points that identify the location of the screwdriver. Z-motion is manually controlled via a linear slide with the aid of a tool balancer.



### EASY PROGRAM INTERFACE BOX

The Smart-Arm is programmed with a Job-Box. The Job-Box steps the operator through the process of manually teaching the correct position, bit/socket and torque program. No PC is required



### POKA-YOKE YOUR PROCESS

Error-proof assembly is achieved through the combined use of the Smart-Arm, Bit/Socket Tray and pre programmed torque values.



## TORQUE TESTER

The K series are totally new classes of torque analyzers. They feature a built-in transducer and also have the unique ability to connect to an external transducer. Using a high performance circuitry they collect, store and eventually download torque measures for a complete analysis of the tool and/or the joint. Priced at a low cost, the tester has become very popular among those companies wishing to improve their product quality through the precise control of torque.



- User friendly menu.
  - Accuracy: +/- 0,5% of the displayed value +/-1 digit.
  - Internal transducer for tests on a joint simulator (supplied with the unit).
  - Connection for external transducer (transducer not included).
  - 500 readings memory.
  - Selection among Nm, Ncm, kg.cm, in.lbs.
  - RS232C output (cable not included).
  - Indication  $\Leftrightarrow$  of the preset values.
  - Output signal at preset reached value.
  - Clockwise and counter-clockwise measurement.
  - 3 modes of operation: Peak + , Peak - , Track.
  - Manual or automatic reset.
  - 9 V rechargeable battery provide 4 hours continuous operation. Automatic switch off to reduce battery consumption.
  - 125% transducer overload protection.
  - English and Italian menu.
- Supplied in a plastic carrying case, with one rechargeable battery, 1 joint simulator (semi-elastic), instruction manual and certificate of calibration.

Additional joint simulators (rundown adapters) for hard joint or fully elastic joint available on request.



JOINT SIMULATOR



EXTERNAL ROTARY TRANSDUCER



CONNECTING PORTS



KEYPAD

Model	Torque in.lbs	Dimensions in	Weight lbs
K1	0.44÷8.8	7.10x4.10x2.15	2.205
K5	2.65÷44	7.10x4.10x2.15	2.205
K20	4.40÷177	7.10x4.10x2.15	2.205

### ROTARY TRANSDUCER

All rotary transducers feature a 1/4" Hex male input drive and a 1/4" Hex female output driver

RTK01	5.0÷50
RTK02	10÷100
RTK03	20÷200



## SCREW PRESENTERS AND AUTOMATIC SYSTEMS

The NFK 500 Series are simple but effective devices where screws are brought to a pick-up position one after another.

A magnetized bit, "autocatcher", or vacuum pick-up attachment is required to chuck the screw. Model NFK 707 is adjustable for any size screw with a dia. from 0.056" through 0.200". Each screw is separated and brought into place for extremely accurate positioning. Units are suitable to feed machine screws, self tapping screws, nuts, studs, or any other threaded fasteners with or without washers.

Model	∅ max shank	Screw length min.	Screw length max
NFK 514	0.056"	0.072"	0.400"
NFK 517	0.068"	0.068"	0.400"
NFK 520	0.080"	0.100"	0.720"
NFK 523	0.092"	0.112"	0.720"
NFK 526	0.104"	0.140"	0.720"
NFK 530	0.120"	0.160"	0.720"
NFK 540	0.160"	0.200"	0.720"
NFK 550	0.200"	0.240"	0.720"
NFK 707	0.056"-0.200"	0.072"	0.720"



### VACUUM ADAPTOR KIT

Model VA-205K-FAB vacuum pick-up system is designed to work with the Kolver FAB series Screwdrivers. The kit includes a vacuum adaptor assembly, 6' hose, and all fittings. Vacuum pump is optional.

Interchangeable screw finders are sold separately. Custom finders, are also available. Vacuum pick-up attachments are used with either Kolver NFK Screw Presenters, with Shaker Trays or with Autocatcher.

Finder P/N	ID	ID	Pre-Bored Hole	Pre-Bored Hole
2-0270-0013	.119"	3.0mm	.067"	1.7mm
2-0270-0014	.139"	3.5mm	.087"	2.2mm
2-0270-0015	.158"	4.0mm	.107"	2.7mm
2-0270-0016	.174"	4.4mm	.123"	3.1mm
2-0270-0017	.310"	7.9mm	.210"	5.3mm

### SHAKER TRAYS: 4"x4" square

Grid Width (mm)	Shaker Tray P/N
3.0	SGQ 30
3.5	SGQ 35
4.0	SGQ 40
4.5	SGQ 45
5.0	SGQ 50
5.5	SGQ 55



GRID WIDTH FOR SPECIFIC SCREW SIZES



AUTOCATCHER



**KSF-5000  
AUTOMATIC SCREWFEEDER**

Autofeed hand screwdrivers are simple and reliable systems where the screw or nut is automatically fed into the driver collet head. The automatic downstroke reduces operator fatigue, dramatically increasing assembly rate and productivity. You can feed and tighten machine and self-tapping screws, nuts, studs and any other threaded fasteners, with or without washers. KSF5000 may be used with FAB, RAF, or PLUTO series drivers.



**ARM PV1 AND TEC BA1 PIVOTING  
ARM AND BALANCER**

Tool balancers TECBA1 allow screwdrivers to be positioned over the work station for comfortable operation. Models with capacity up to 600 lbs available on request.



**TORQUE REACTION ARM**

Torque reaction arms PA2KOL have been designed to eliminate the reaction generated by screwdrivers when they stop at the pre-set torque up to 176 lbs. Options include table or wall mount and tool holders for inline or pistol screwdrivers.

**MICRO TOOL TORQUE LIMITING  
SCREWDRIVERS**

These manual torque drivers are designed for customers that require a precision, preset, manual torque screwdriver.

- Designed and tested to meet or exceed ISO 6789 specifications.
- 1/4" female hexagon bit socket
- Precision sealed ball bearing for clean, smooth operation
- Torque driver can be set to a customer specified torque value prior to shipping
- Cam mechanism with suspended adjustable thrust and axial bearings.



MT-1	torque range	0.5 - 16 in/oz
MT-2	torque range	0.7 - 32 in/oz
MT-3	torque range	3 in/oz - 12 in/lb
MT-4	torque range	8 in/oz - 36 in/lb

**KVA-10**

KVA-10 is our lighter duty torque arm (rated to 120 in. lbs of torque).

This arm has a working range of 8" to 28", and is shipped complete, ready to mount. The unit includes working arm, adjustable tool mount (accepts 1" - 2" dia. drivers) and bench-top mounting rackets.



**VACUUM PUMP**

Model #3-0170-0006 is a self container vacuum pump, drawing 25" mercury. Optional dualportconnector is available for powering 2 vacuum units. Contact factory for details.





## ONE YEAR LIMITED WARRANTY

KolverUSA, LLC. ("Kolver") warrants that each product sold by it shall be free from defects in material and workmanship under normal application, use and service for a period of one (1) year from the date of shipment by Kolver or its distributors to the initial purchaser. Kolver's sole obligation under this warranty is, in Kolver's sole discretion, to repair or replace free of charge during the warranty period, any part or parts found to be defective, provided that the product (i) is delivered, postage prepaid, to KolverUSA, LLC, Woodland Park, One Park Drive, Unit 9, Westford, MA 01886; (ii) has not been misused, subjected to unusual stress, modified or serviced in any manner. THIS WARRANTY IS IN LIEU OF ALL OTHER WARRANTIES, EXPRESSED OR IMPLIED, WRITTEN OR ORAL, INCLUDING WITHOUT LIMITATION THE IMPLIED WARRANTIES OF MERCHANTABILITY AND OF FITNESS FOR A PARTICULAR PURPOSE. IN NO EVENT SHALL KOLVER BE LIABLE FOR ANY INCIDENTAL, CONSEQUENTIAL, SPECIAL OR OTHER DAMAGES IN EXCESS OF THE REPLACEMENT COST OF THE DEFECTIVE PART(S). KOLVER'S OBLIGATIONS HEREUNDER SHALL TERMINATE THREE (3) YEARS FROM THE DATE OF THE ORIGINAL SHIPMENT.



One Park Drive, Unit 9,  
Westford, MA 01886  
Phone: 1-978-692-5166  
Fax: 978-692-3042  
Web site: [www.kolverusa.com](http://www.kolverusa.com)